

KEP 29/36 LG

Enlargement adaptor, polyamide, RAL 7035, Pg29 / Pg36



Products may differ in size, colour and appearance to those shown. If you require further information or customisation, please contact us directly.



| | |
|---------------------------------|-----------------------------|
| Material | Polyamide, fibre reinforced |
| Temp. range min | -40 °C |
| Temp. range max | 100 °C |
| Glow wire test | 650 °C |
| Thread type outer | PG |
| Ø outer thread | 29 |
| Length screw-in thread L | 12 mm |
| Thread type inner | PG |
| Ø inner thread | 36 |
| Length internal thread | 15,5 mm |
| Total length TL | 30 mm |
| Key width SW | 53 mm |
| Collar diameter (E) | 59 mm |
| Product Color | RAL 7035 |
| Order no. RAL 7035 | 10063601 |
| Type | KEP 29/36 LG |
| Packing unit | 20 |
| EAN number | 4007685636018 |
| Tariff number | 39269097 |
| ETIM-Classification | EC000938 |

Recommended accessories

| | |
|------------------|----------|
| MUG 29 LG | 10060676 |
|------------------|----------|

Your Contact:

WISKA India Pvt. Ltd.

Mr. Omkar Ashar · Unit No.247/248,Raheja Tesla Industrial District II , Edison Bldg No.-1A,
Plot No.GEN2/1/C/PART, TTC Industrial Area, MIDC, Juinagar, Navi Mumbai 400705, India

☎ +91-22-4967-1438 · ☎ +91-22-4967-1439 · o.ashar@wiska.in · www.wiska.in

23.05.2026

Your Contact:

WISKA India Pvt. Ltd.

Mr. Omkar Ashar · Unit No.247/248,Raheja Tesla Industrial District II , Edison Bldg No.-1A,
Plot No.GEN2/1/C/PART, TTC Industrial Area, MIDC, Juinagar, Navi Mumbai 400705, India

☎ +91-22-4967-1438 · ☎ +91-22-4967-1439 · o.ashar@wiska.in · www.wiska.in

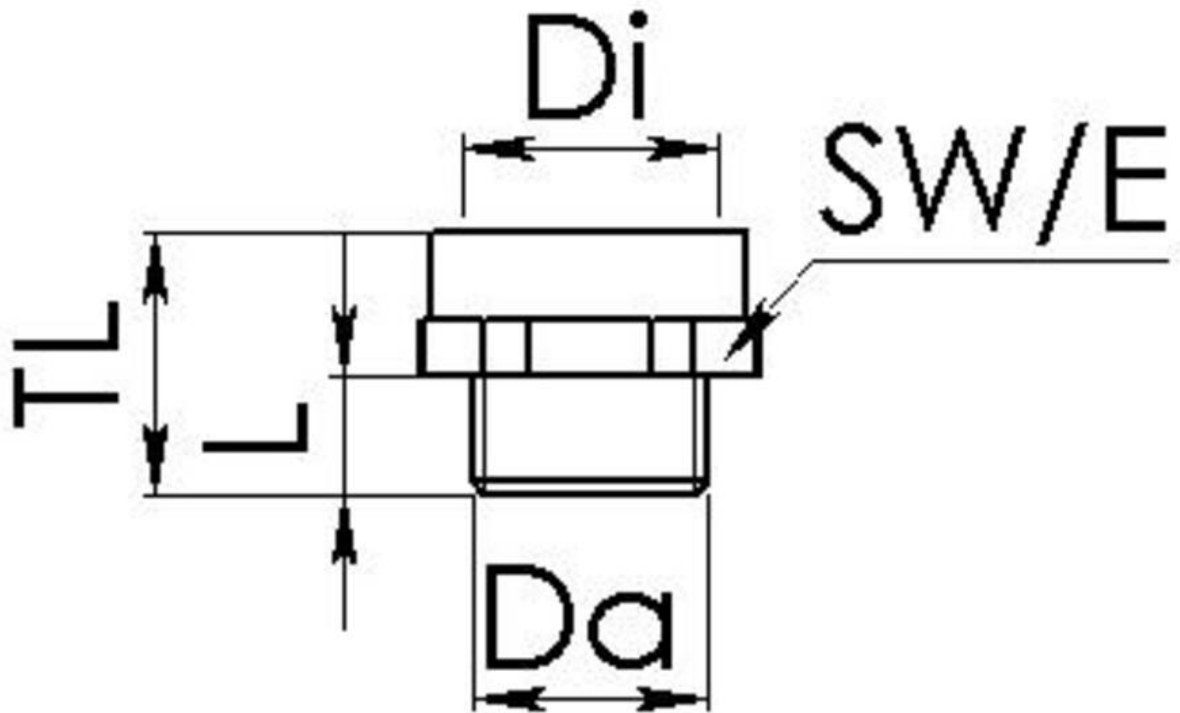

Your Contact:

WISKA India Pvt. Ltd.

Mr. Omkar Ashar · Unit No.247/248,Raheja Tesla Industrial District II , Edison Bldg No.-1A,
Plot No.GEN2/1/C/PART, TTC Industrial Area, MIDC, Juinagar, Navi Mumbai 400705, India

☎ +91-22-4967-1438 · ☎ +91-22-4967-1439 · o.ashar@wiska.in · www.wiska.in

Other technical data on request / subject to change without notice