

PH-SSF-16D-WT

Schuko double sockets flush mounting, 230V IP44, plastic, white

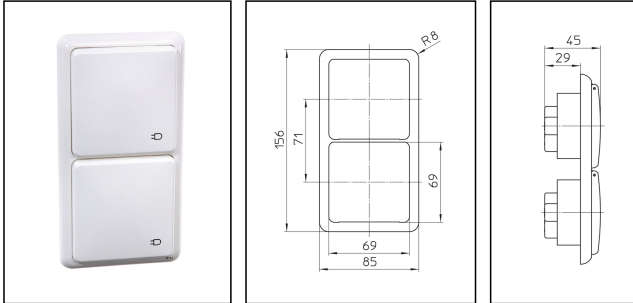

Products may differ in size, colour and appearance to those shown. If you require further information or customisation, please contact us directly.



WISKA-Order no.	50015719
Type	PH-SSF-16D-WT
Voltage	250 V
Current	16 A
Protection class	IP44
Material	Thermoplastic
External dimensions LxWxH	85x156x5,5mm
Socket insert	SCHUKO
Terminals/poles	2-pole + E
Weight	0,21 kg
Colour	Pure white, similar RAL 9010
Mounting	Recessed mounting
Variations	on request
Tariff number	85366990

Remarks:

- crushproof
- with hinged cover and 2-gang frame

Recommended accessories

Box 2-gang Kaiser 9062-02	50100411
----------------------------------	----------

12.05.2026

Your Contact:

WISKA India Pvt. Ltd.

Mr. Omkar Ashar · Unit No.247/248,Raheja Tesla Industrial District II , Edison Bldg No.-1A,
Plot No.GEN2/1/C/PART, TTC Industrial Area, MIDC, Juinagar, Navi Mumbai 400705, India

☎ +91-22-4967-1438 · ☎ +91-22-4967-1439 · o.ashar@wiska.in · www.wiska.in

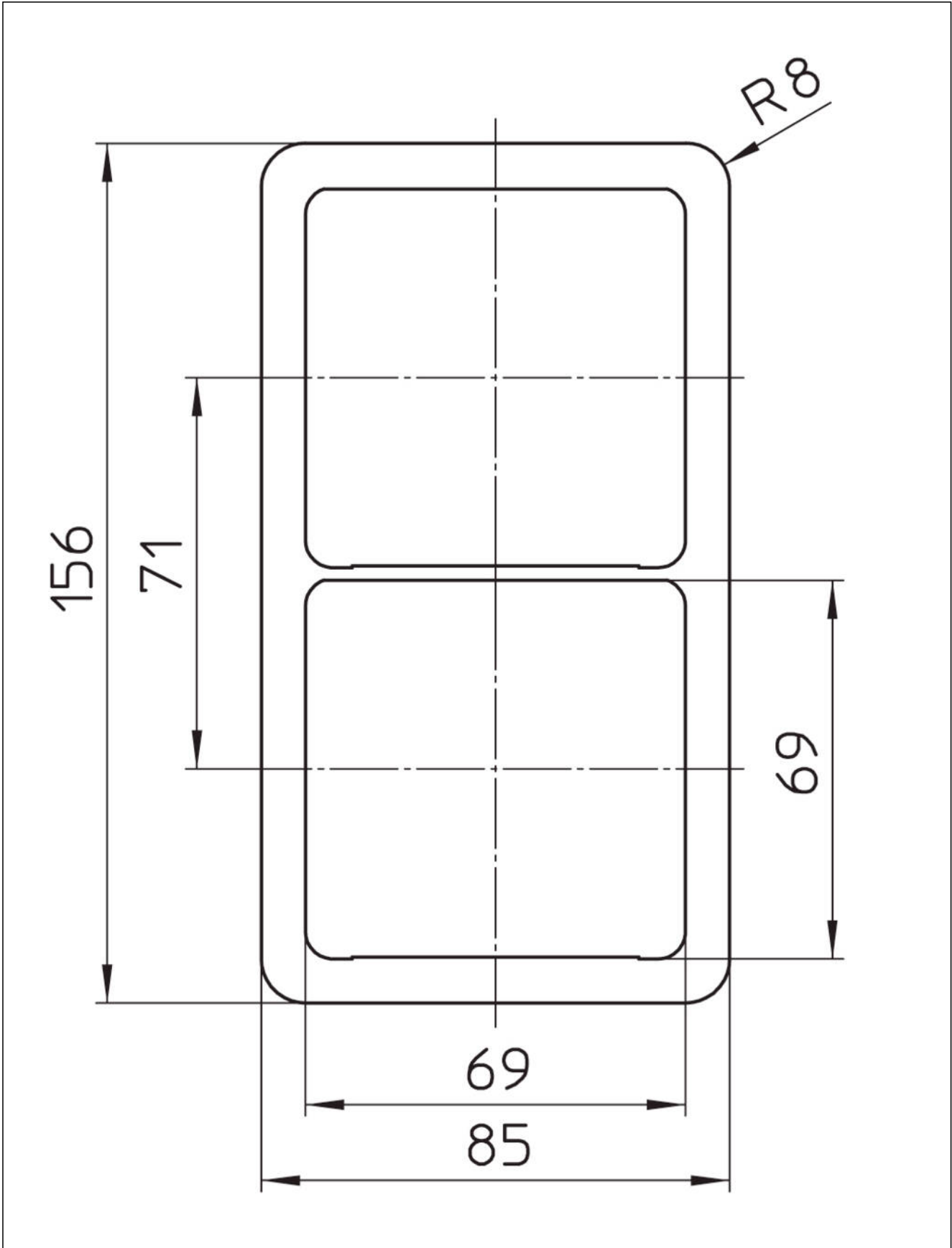

Your Contact:

WISKA India Pvt. Ltd.

Mr. Omkar Ashar · Unit No.247/248,Raheja Tesla Industrial District II , Edison Bldg No.-1A,
Plot No.GEN2/1/C/PART, TTC Industrial Area, MIDC, Juinagar, Navi Mumbai 400705, India

☎ +91-22-4967-1438 · ☎ +91-22-4967-1439 · o.ashar@wiska.in · www.wiska.in

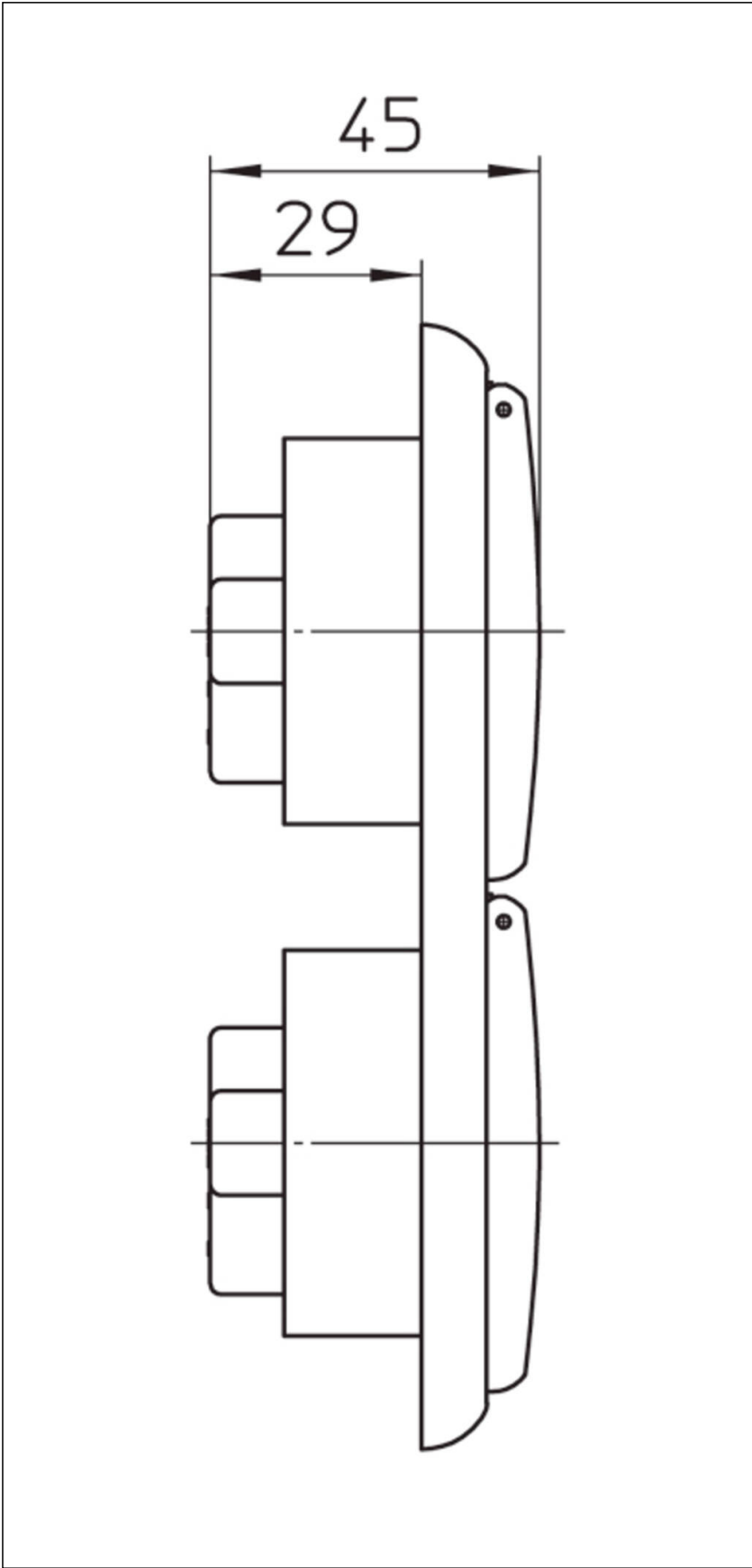

Your Contact:

WISKA India Pvt. Ltd.

Mr. Omkar Ashar · Unit No.247/248,Raheja Tesla Industrial District II , Edison Bldg No.-1A,
Plot No.GEN2/1/C/PART, TTC Industrial Area, MIDC, Juinagar, Navi Mumbai 400705, India

☎ +91-22-4967-1438 · ☎ +91-22-4967-1439 · o.ashar@wiska.in · www.wiska.in